

INSTALLATION INSTRUCTIONS FOR ITCH ASSEMBLY

1. Install ITCH Assembly into enclosure per drawing, dimensions, and template below.
2. In potentially freezing climates, it is very important to trap the steam inlet before it enters the enclosure to assure that it stays hot even when the enclosure controller turns off steam to the heater. For this reason, two TV/HAT traps are included; one for the inlet line trap and one for the heater outlet.

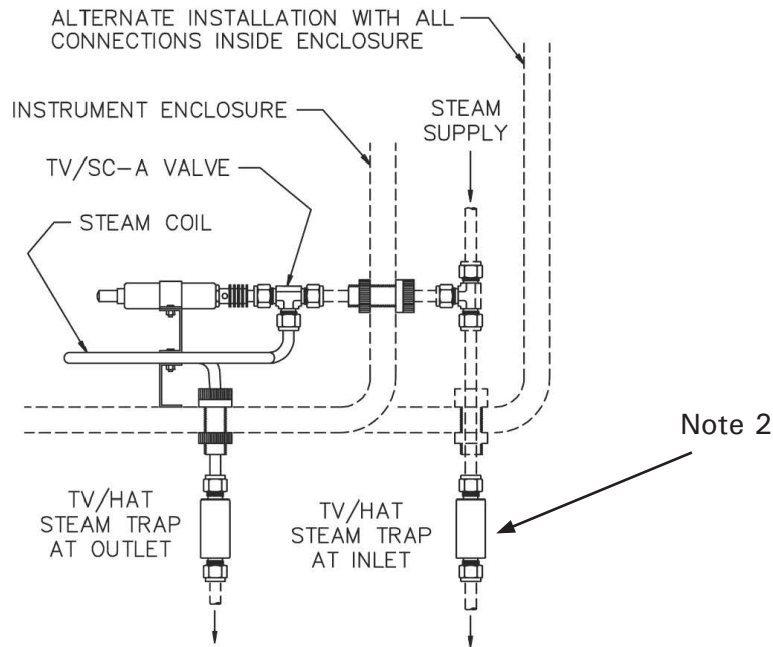

MOUNTING DIMENSIONS

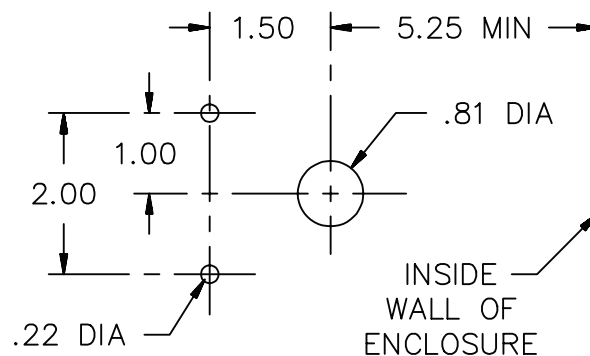

Proper Use: Use ThermOmegaTech® products only as specified to ensure performance, safety, and regulatory compliance.

No Modifications: Do not modify ThermOmegaTech® products, as changes may void warranties and violate regulations (e.g., RoHS, REACH).

Proper Disposal: Dispose of end-of-life products per local hazardous substance regulations; contact ThermOmegaTech® or recycling facilities for guidance.

 **WARNING:** This product can expose you to chemicals, for example lead, nickel, acrylonitrile, which are known to the State of CA to cause cancer, birth defects, or reproductive harm. For more information, go to www.P65Warnings.ca.gov

Warranty information disclosed at www.thermomegatech.com/terms-conditions/

ITCH_IM1
REV: 9/26/2025