

INSTALLATION INSTRUCTIONS 3/4" GURU PC® CARTRIDGE ASSEMBLY 60 AND 120 PSI RAIL PASSENGER CAR

To change the cartridge assembly of your 3/4" GURU PC valve follow the instructions listed below.

Disassembly

1. Isolate valve or drain system.
2. Use 1 1/2" hex flats on cap to remove the cap assembly from installed valve.
3. Confirm the cap assembly shown in Figure 1 is removed from valve (no internal parts are to be reused).
4. Use non-marking pad or cotton rag to clean threads, internal surfaces of body and valve port of all dirt/grime and mineral buildup.

Assembly

1. Place Spring on plug assembly and insert into valve body.
2. Confirm domed end of piston is visible as shown in Figure 2.
3. Insert factory-calibrated cap assembly into the valve body and tighten wrench tight to 50 ft/lb.
4. Spray actuator with freeze spray or freeze wand and confirm valve opens within 5-15 Seconds (Opens then Closes).

Figure 1

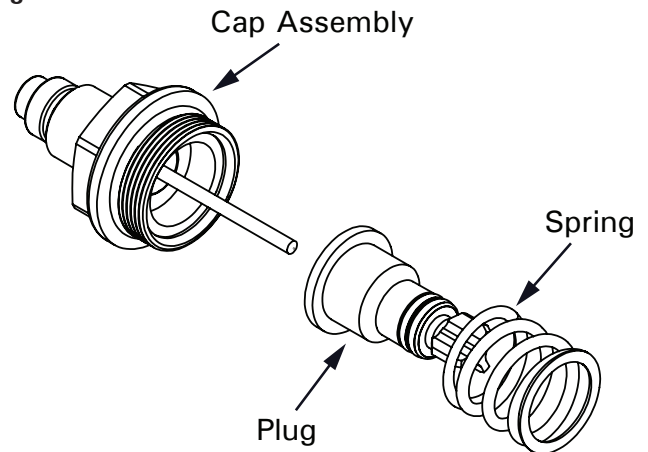

Figure 2

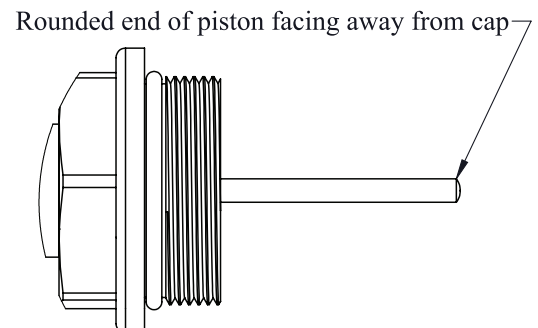
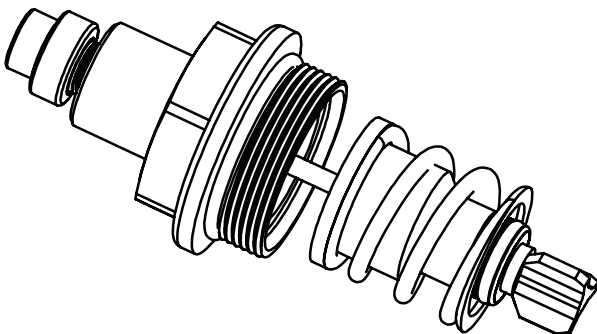

Figure 3



WARNING: This product can expose you to chemicals, for example lead, nickel, acrylonitrile, which are known to the State of CA to cause cancer, birth defects, or reproductive harm. For more information, go to www.P65Warnings.ca.gov

Warranty information disclosed at www.thermomegatech.com/terms-conditions/

3/4GURUPC-CARTRIDGE
ASSEMBLY_IM1
REV: 6/29/21